

MHDTZK-RA-BK Series | Die Cast D-Sub Hood

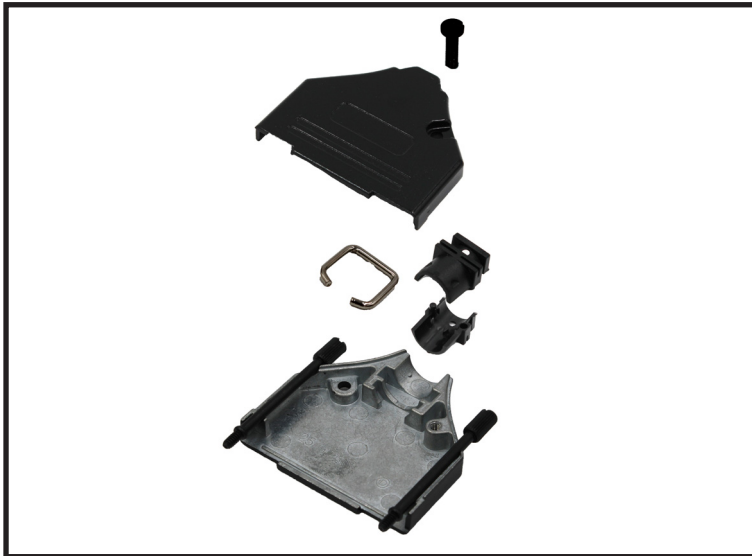

Description

- Available in 9,15, 25 , 37 or 50 way
- Re-openable
- Cable entry, Top entry,
- Operating Temperature, -40°C to 120°C
- Will accommodate up to 13 mm diameter cable
- 4-40UNC Jackscrews

The Kit Contains:

- | | |
|-----------------------|-----|
| Backshell halves | x 2 |
| 4-40 Jackscrews | x 2 |
| Plastic cable inserts | x 2 |
| Backshell screws | x 2 |
| C-Clip | x 1 |

Specification

- Ways: 9, 15, 25, 37 or 50
- Housing Material: Die Cast Zinc Alloy
- Cable Entry: Straight, 90° or Side
- Cable OD: Up to 13mm

Dimensions			
Size	A	B	C
09	31.2	34.9	15.0
15	39.5	41.5	15.0
25	53.4	48.6	47.0
37	69.7	53.6	15.0

