

THIS IS A C.A.D. GENERATED DRAWING
DO NOT MAKE MANUAL REVISIONS TO MASTER.

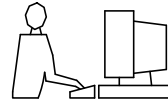

* UNLESS OTHERWISE SPECIFIED TOLERANCES
ON DECIMAL IS: ANGLE $\pm 1^\circ$
UNIT: MM .XX ± 0.35

BACKSHELL KIT INCLUDES:

- (2)BACKSHELL HALVES
- (2)4-40 THUMBSCREWS
- (2)HOUSING SCREWS
- (2)CLAMP SCREWS
- (1)METAL CLAMP
- (1)SET OF COMPRESSION INSERTS-VARIOUS SIZES
DIAMETERS 11mm(.433"), 12.5mm(.492"), 14mm(.551"), 15mm(.591")

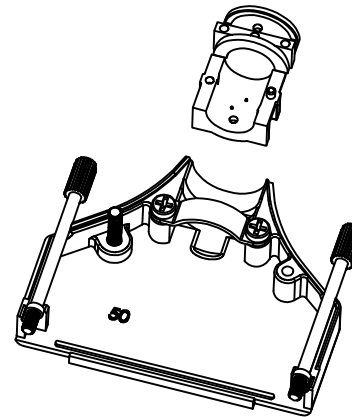
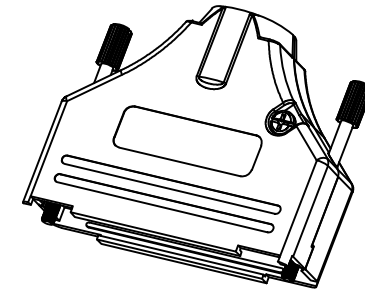
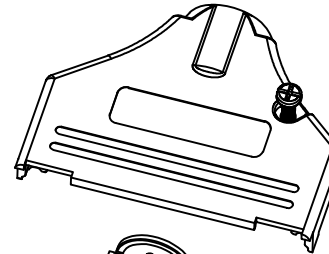
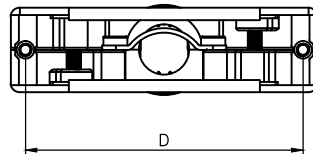
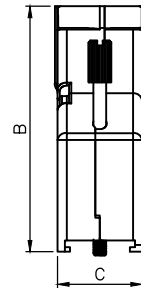
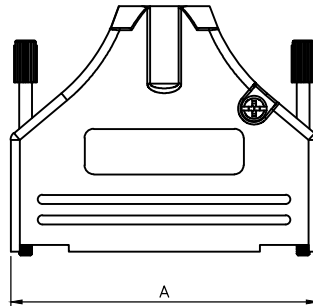

DIMENSIONS(mm/in)				
SIZE	A $\pm_{0.02}^{.50}$	B $\pm_{0.02}^{.50}$	C $\pm_{0.02}^{.50}$	D $\pm_{0.01}^{.25}$
50	67.50	54.00	18.70	61.00
	2.657	2.126	0.736	2.402

BACKSHELL MATERIAL:	DIE-CAST ZINC ALLOY
PLATING:	NICKEL
JACKSCREWS:	STEEL:ZN PLATED
M3 HOODSCREWS:	STEEL:ZN PLATED
CLAMP SCREWS:	STEEL:ZN PLATED
METAL CLAMP:	STEEL:NICKEL PLATED
COMPRESSION INSERT:	ABS,UL RECOGNIZED,NICKEL PLATED
OPERATING TEMP:	-40°C TO+120°C

THESE DRAWINGS AND SPECIFICATIONS ARE THE PROPERTY OF MH CONNECTORS AND SHALL NOT BE REPRODUCED, COPIED OR USED AS THE BASIS FOR THE MANUFACTURE OR SALE OF APPARATUS WITHOUT WRITTEN PERMISSION.

DRAWN Johnny	DATE 02-21-23
-----------------	------------------

APPROVED Victor Lin	DATE 02-21-23
------------------------	------------------

SCALE 1 : 1	SHEET OF 1 OF 1	REV: 1.0
----------------	--------------------	-------------

DRAWING No
MHDTZK50-RA-HI-K



THIS SERIES FULLY CONFORMS TO THE EUROPEAN UNION DIRECTIVES 2015/863/EU AND 2011/65/EU FOR RoHS COMPLIANCY.



**MH CONNECTORS ,
DIVISION OF EDAC**