

THIS IS A C.A.D. GENERATED DRAWING
DO NOT MAKE MANUAL REVISIONS TO MASTER.

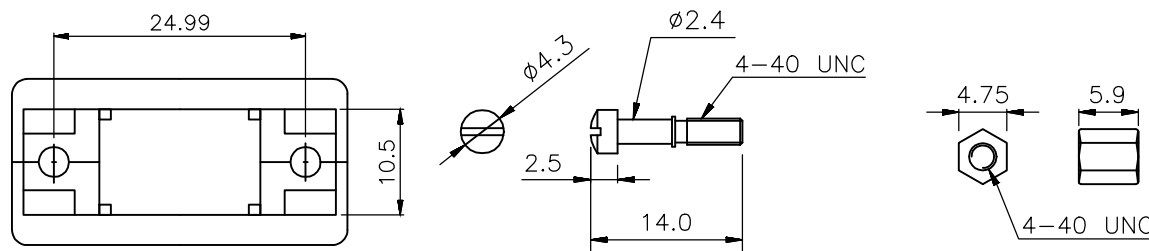

* UNLESS OTHERWISE SPECIFIED TOLERANCES
ON DECIMAL IS: ANGLE ± 5°
UNIT: MM X. ± 0.5
.X ± 0.3
.XX ± 0.2



SPECIFICATION:

1. INSULATOR: ABS UL94HB.
2. SCREW: STEEL.
3. FINISHED: CHROMATE PLATED.
4. PARTS OPTION:
M/M= 4PCS SHORT SCREW ONLY.
M/F= 4PCS SHORT SCREW+2PCS HEX-NUT.
F/F= 4PCS SHORT SCREW+4PCS HEX-NUT.

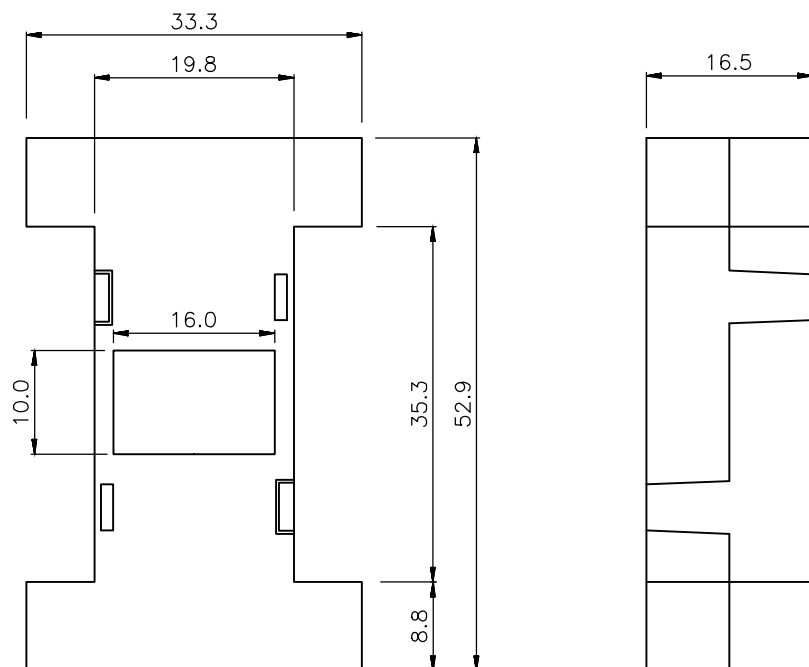

PARTS OPTION	WIRE DESCRIBE
M/M	Black, brown, red, orange, yellow, green, blue, grey, white. Each 1 pcs yellow 1 M to 2 M : 1 pcs.
M/F	Black, brown, red, orange, yellow, green, blue, grey, white. Each 1 pcs Yellow 1 M to 2 M :1 pcs , 1F to 2M :1 pcs .
F/F	Black, brown, red, orange, yellow, green, blue, grey, white. Each 1 pcs yellow 1 F to 2 F : 1 pcs.

ORDERING INFORMATION:

UNSHIELDED VERSION

SIZE	P/N - KITTED	PRODUCT CODE
9-WAY	2111-0101-01	MHGA0909-MM-LG-K-RC
9-WAY	2111-0101-11	MHGA0909-MF-LG-K-RC
9-WAY	2111-0101-21	MHGA0909-FF-LG-K-RC

ORDERING INFORMATION:

SHIELDED VERSION

SIZE	P/N - KITTED	PRODUCT CODE
9-WAY	2111-0105-01	MHGA0909-MM-M-K-RC
9-WAY	2111-0105-11	MHGA0909-MF-M-K-RC
9-WAY	2111-0105-21	MHGA0909-FF-M-K-RC

THESE DRAWINGS AND SPECIFICATIONS ARE THE PROPERTY OF MH CONNECTORS LTD. AND SHALL NOT BE REPRODUCED, COPIED OR USED AS THE BASIS FOR THE MANUFACTURE OR SALE OF APPARATUS WITHOUT WRITTEN PERMISSION.

DRAWN
JOHNNY
DATE
07-17-13

APPROVED
DAMIEN
DATE
01-07-14

SCALE SHEET OF REV:
1 OF 1 3.0

DRAWING No
MHGA0909-XX-XX-K-RC



THIS SERIES FULLY CONFORMS TO THE EUROPEAN UNION DIRECTIVES 2002/95/EC AND 2002/96/EC FOR RoHS COMPLIANCY.



MH CONNECTORS LTD.