

THIS IS A C.A.D. GENERATED DRAWING  
DO NOT MAKE MANUAL REVISIONS TO MASTER.

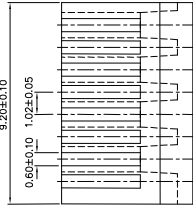

LOAD BAR 1.1mm

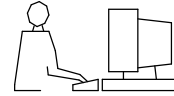
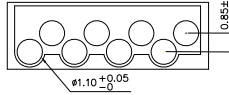
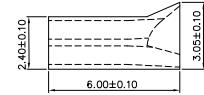

CONTACT TYPE  
2 PRONGS FOR STRANDED WIRE

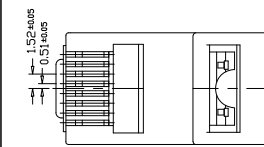
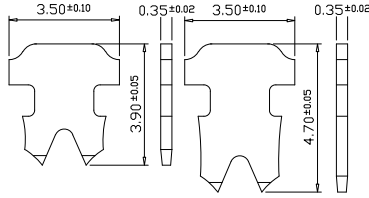

no/cable clamp & no/shield  
MHRJ C6A R 2 XNX

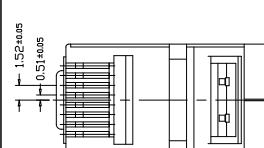
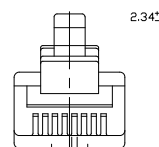

no/cable clamp & w/shield  
MHRJ C6A R 2 X1X

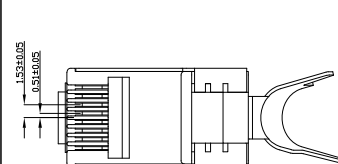
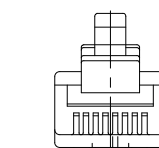

w/cable clamp & w/shield  
MHRJ C6A R 2 X2X

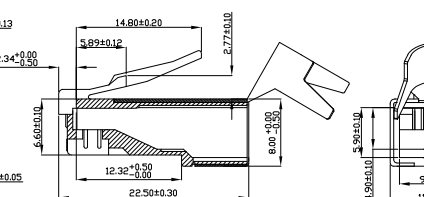
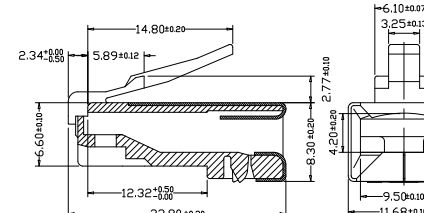
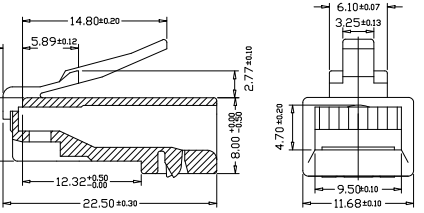

BOOT

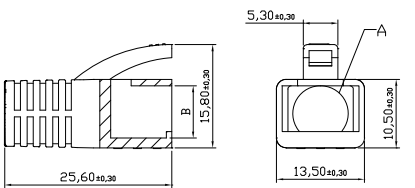
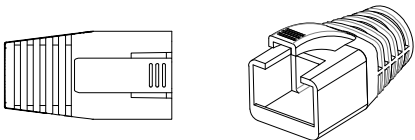

A Dim m/m	B Dim m/m
5.5±0.10	8.0±0.10
6.0±0.10	8.0±0.10
6.5±0.10	8.0±0.10
7.0±0.10	8.0±0.10
7.5±0.10	8.0±0.10
8.0±0.10	8.0±0.10
8.5±0.10	8.0±0.10

MHRJ C6A R 2 X X X

NOTES:  
ELECTRICAL:  
1. Voltage Rating: 250V AC max  
2. Current Rating: 2A  
3. Contact Resistance: 20mΩ max  
4. Insulation Resistance: 500MΩ min  
5. Dielectric Withstanding Voltage: 1000 VDC/min, < 0.5A

MECHANICAL:  
1. Housing Material: Polycarbonate (PC), UL94V-2, Color - Clear  
2. Shielding Material: Brass with Nickel Plating  
3. Contact: Material: Phosphor Bronze  
Plating: Gold 50µ" (≥1.27µm) over Nickel 50µ" (≥1.27µm)  
4. Load Bar Material: 1.1mm: Polycarbonate (PC), UL94V-2  
5. Wire: 23-26 AWG  
6. Mating Cycles: 2000  
7. Boot Material: PVC

ENVIRONMENTAL:  
1. Operating Temperature: -40°C to +125°C

REACH & FCC compliant

#	Type	Recommended Cable OD (limited by connector)	#	Boot Color
1	Conn plug only	4.5-6.3mm	N	No Boot Included
2		5.9-8.5mm	1	Black
3	Conn Plug + Boot kit	Up to 6.0mm	2	Blue
4		Up to 6.5mm	3	Dark Grey
5		Up to 7.0mm	4	Green
6		Up to 7.5mm	5	Light Grey
7		Up to 8.0mm	6	Purple
8		Up to 8.5mm	7	Red
			8	Yellow
			9	White



THIS SERIES FULLY CONFORMS TO THE EUROPEAN UNION DIRECTIVES 2015/863/EU AND 2011/65/EU FOR RoHS COMPLIANCY.



THESE DRAWINGS AND SPECIFICATIONS ARE THE PROPERTY OF MH CONNECTORS AND SHALL NOT BE REPRODUCED, COPIED OR USED AS THE BASIS FOR THE MANUFACTURE OR SALE OF APPARATUS WITHOUT WRITTEN PERMISSION.

DRAWN	E.P.	DATE
APPROVED	C.R.	DATE
SCALE	SHEET OF	REV:
DRAWING No	1 OF 1	1

MH 8P8C RJ45 Cat6A  
MOD PLUG

MHRJC6AR2XXX